



Neupro[®]
(rotigotine transdermal system)

NEUPRO **Product Use** **Brochure**

A Guide for Patients

NEUPRO is a prescription medicine used to treat Parkinson's disease and moderate-to-severe primary Restless Legs Syndrome.

Please see Important Safety Information inside and accompanying full Prescribing Information.

Instructions for Use

Follow this guide to apply NEUPRO[®] (rotigotine transdermal system). Read the Patient Information and Instructions for Use inside the NEUPRO box for complete instructions on the right way to use NEUPRO.

When to Apply NEUPRO

- NEUPRO should be applied right away after removing it from the protective pouch. Do not damage or cut your NEUPRO Patch into smaller pieces
- Choose the time of day or night that works best for you to apply your NEUPRO Patch. Apply it at the same time each day
- Wear your NEUPRO Patch for 24 hours. After 24 hours, remove your NEUPRO Patch and apply a new one right away to a different area of skin

Where to Apply NEUPRO

- Choose an area of clean, dry, and healthy skin on the stomach, thigh, hip, side of the body between the ribs and the pelvis (flank), shoulder, or upper arm
- Apply your NEUPRO Patch to a different place on your skin each day. Switch between the right and left sides and the upper and lower body. NEUPRO should not be applied to the same area of skin more than once every 14 days
- Apply NEUPRO to a different area of skin (only one of the indicated areas) each day to reduce the chance of skin irritation
- If you need to apply your NEUPRO Patch to a hairy area, the area should be shaved at least 3 days before applying the patch
- Avoid applying your NEUPRO Patch to areas where it could be rubbed by tight clothing or a waistband
- Avoid applying your NEUPRO Patch on skin folds
- **Do not** apply your NEUPRO Patch to skin that is red, irritated, or injured

- Avoid applying creams, lotions, ointments, oils, and powders to the skin area where your NEUPRO Patch will be placed

Patch Placement Map

This body map shows the areas where you can apply NEUPRO. Use the figures below to track your patch placement over 14 days.

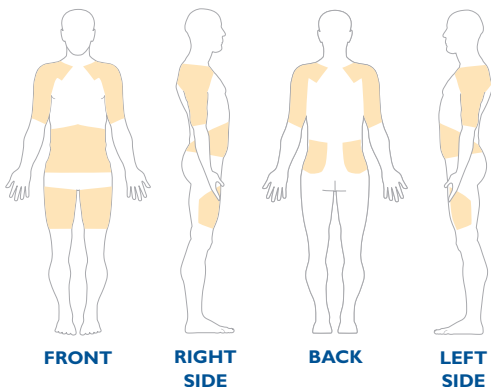

 Application sites

For more information and a video about how to apply the NEUPRO Patch, please visit www.NEUPRO.com

How to Apply NEUPRO

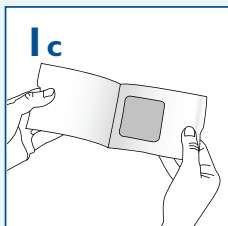
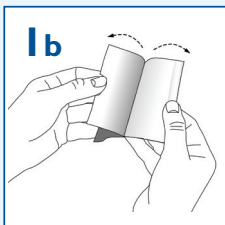

- 1.** Grasp the 2 sides of the pouch and pull apart.

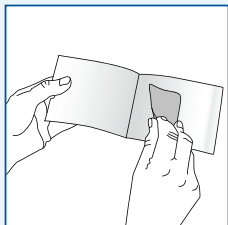

- 2.** Remove the patch from the pouch.

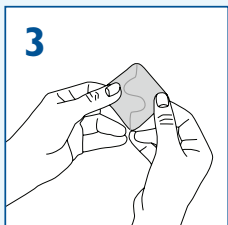

3. Hold the patch with both hands, with the protective liner on top.

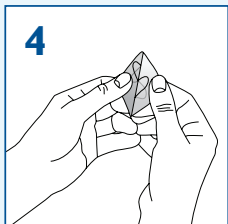

4. Bend the edges of the patch away from you so the S-shaped cut in the liner opens up.

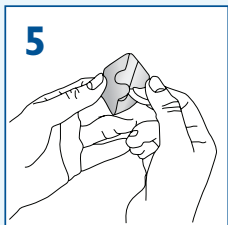

5. Peel off one half of the protective liner. **Do not** touch the sticky surface because the medicine could come off on your fingers.

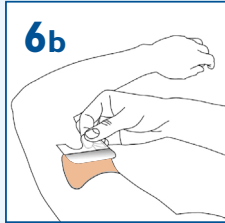
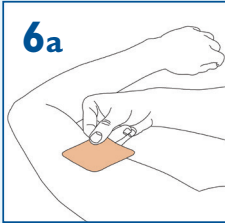

6. Apply the sticky half of the patch to a clean area of skin and remove the remaining liner.

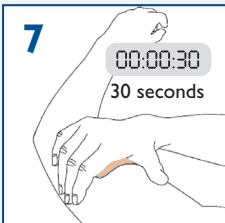

7. Press the patch firmly with the palm of your hand for **30 seconds** to make sure there is good contact with your skin, especially around the edges. The warmth of your hand helps the adhesive

on the patch to stick to your skin. Make sure the patch is flat against your skin. There should be no bumps or folds.

-
8. Wash your hands with soap and water right after handling the patch. **Do not** touch your eyes until after you have washed your hands.

How to Remove NEUPRO

1. Slowly and carefully peel off your used NEUPRO Patch. Carefully fold it in half (sticky sides together) and throw it away so that children and pets cannot reach it.
2. Gently wash the area with warm water and mild soap to remove any sticky material (adhesive) that stays on the skin.
3. Baby or mineral oil may also be used to remove any adhesive. Avoid using alcohol or other solvents, such as nail polish remover. They may cause your skin to become irritated.
4. Wash your hands with soap and water.
5. You may see mild redness at the site when a patch is removed, like when you remove an adhesive bandage. This redness should go away over time. If irritation or itchiness continues, tell your doctor.



Neupro[®]
(rotigotine transdermal system)

Instructions continued on reverse side.

Please see Important Safety Information on reverse side and accompanying full Prescribing Information.

Other Information

- You may bathe, shower, or swim while wearing a NEUPRO Patch. Water may loosen your patch
- If the edges of the patch lift, you may tape them down with bandaging tape
- If your NEUPRO Patch falls off, apply a new patch for the rest of the day. The next day, apply a new patch at your regular time
- If you miss a dose or forget to change your NEUPRO Patch, apply a new patch as soon as you remember. The next day, apply a new patch at your normal time

- Avoid exposing the site where you have applied your NEUPRO Patch to heating pads, electric blankets, heat lamps, saunas, hot tubs, heated water beds, and direct sunlight. Too much medicine could be absorbed into your body
- Talk to your doctor often about your condition.
Do not stop or change your treatment with NEUPRO without talking to your doctor

Indication

NEUPRO[®] (rotigotine transdermal system) is a prescription medicine used to treat Parkinson's disease and moderate-to-severe primary Restless Legs Syndrome.

Important Safety Information

NEUPRO contains a sulfite called sodium metabisulfite. Sulfites can cause severe allergic reactions that are life threatening to some people who are sensitive to sulfites. People with asthma are more sensitive to sulfites. Remove the patch right away and call your doctor if you have swelling of the lips or tongue, chest pain, or trouble breathing or swallowing.

NEUPRO may make you fall asleep suddenly or without warning while doing normal activities, such as driving, which may result in accidents. Tell your doctor right away if this happens. Drinking alcohol or taking other medicines that cause drowsiness may increase your chances of becoming sleepy while using NEUPRO. Do not drive, use hazardous machinery, or do other dangerous activities until you know how NEUPRO affects you.

NEUPRO can cause or worsen psychotic symptoms including hallucinations (seeing or hearing things that are not real), confusion, excessive suspicion, aggressive behavior, agitation, delusional beliefs



(believing things that are not real), and disorganized thinking in patients with Parkinson's disease or Restless Legs Syndrome. The chances of having hallucinations or these other psychotic-like changes are higher in people with Parkinson's disease who are elderly, taking NEUPRO, or taking higher doses of NEUPRO. If you have any of these problems, talk to your doctor:

NEUPRO can cause decreases in blood pressure, especially when you start or increase your dose. Increases in blood pressure and heart rate, fainting, weight gain, and fluid retention also can occur. If you faint or feel dizzy, nauseated, or sweaty when you stand up from sitting or lying down, or have an unusually fast increase in weight, swelling, or fluid retention, especially in the ankles or legs, tell your doctor:

Some patients using NEUPRO get urges to behave in a way that is unusual for them, such as unusual urges to gamble, strong urges to spend money, binge eating, or increased sexual urges and behaviors. If you or your family notices you are developing any unusual behaviors, talk to your doctor:

NEUPRO may cause uncontrolled, sudden movements or make such movements you already have worse or more frequent if you have Parkinson's disease, which may mean that your anti-Parkinson's medicine needs to be changed. NEUPRO also may cause Restless Legs Syndrome symptoms to come back (rebound), become worse, or start earlier in the day.

Skin reactions may occur at the site where you apply NEUPRO. Tell your doctor if you get a rash, redness, swelling, or itching that will not go away.

Avoid exposing the NEUPRO patch you are wearing to heating pads, electric blankets, heat lamps, saunas, hot tubs, heated water beds, and direct sunlight.

Too much medicine could be absorbed into your body. Also, do not wear NEUPRO during medical procedures called magnetic resonance imaging (MRI) or cardioversion because this could cause skin burns.

Tell your doctor if you have breathing problems, a sleep disorder, mental problems, high or low blood pressure, or heart problems; are pregnant or plan to



become pregnant; or are breastfeeding or plan to breastfeed. NEUPRO may not be right for you.

The most common side effects in people taking NEUPRO for Parkinson's disease are nausea, vomiting, sleepiness, application site reactions, dizziness, loss of appetite, difficulty falling asleep and staying asleep, increased sweating, vision problems, leg swelling, and uncontrolled, sudden movements of the arms or legs. The most common side effects in people taking NEUPRO for Restless Legs Syndrome are application site reactions, nausea, difficulty falling asleep and staying asleep, sleepiness, and headache.

You are encouraged to report negative side effects of prescription drugs to the FDA. Visit www.fda.gov/medwatch or call 1-800-FDA-1088. You may also report side effects to UCB, Inc. at [ucbCARES®](http://ucbCARES.com) (1-844-599-2273).



Neupro[®]
(rotigotine transdermal system)

**For more information
and a video about
how to apply the
NEUPRO Patch, please
visit www.NEUPRO.com**



NEUPRO[®] and ucbCARES[®] are registered trademarks
of the UCB Group of Companies.
©2020 UCB, Inc., Smyrna, GA 30080.
All rights reserved.
US-P-NE-PD-2000050